

Line Blind Valves

SOLUTIONS FOR INDUSTRIES

www.StrahmanValves.com



STRAHMAN Global Industry Alliance

Total equipment isolation valves are never 100% reliable. For this reason, most safety regulations require positive shutoff devices such as Line Blinds. This is especially true in high-temperature, critical services. Strahman Line Blinds combine 100% positive shutoff with very quick actuation. This reduces the time-consuming changes of standard spectacle plates. They are specifically designed for a wide range of temperatures and meet the API 607 rev.4 fire safe standards.

Strahman pioneered the development of the non-spreading and quick-action Line Blinds and was the first company to receive Lloyd's of London certification for the its Line Blinds used in cryogenic application such as LNG.

Our technology and expertise provides you with an extensive range of standard Line Blinds and the ability to design a solution that meets your unique application.

All Strahman Line Blinds:

- Save time: Require minimal maintenance and provides ease of operation.
- Prevent product contamination.
- Comply with ASME B31, ANSI 16.5 and API 590 and meets international DIN, API, TUV AND LUFT standard as required.
- Certified for Canadian applications-CRN 0C08554



700 Series



760 Series



740 Series

Most Extensive Choices for Line Blinds!

FEATURES

- Quick change & easy operation – One operator can blind/unblind up to a 24" pipeline safely by operating the hand wheel.
- Wide range of product applications – Ideal for gas, fuel, solvents, LNG, petroleum products, slurries, powders, chips, and mixing liquids.
- Locking devices – Avoid operational error and unsafe operation.
- Auto positioning of spectacle – Sets the spectacle plate in the correct position each time the blind is thrown.
- Ideal for space restrictions – Allows for blinding pipelines where space is limited.
- Unique gearset and seat design – Creates clearance within the Line Blind body without movement of the adjacent piping.

BENEFITS

- Absolute shutoff – Liquid and gas cannot leak downstream.
- Quick change – Heavy pipe lines can be blinded safely within 30 sec. - 2 min.
- Only one operator – One person can operate with ease and safety up to 24".
- Non line spread – Eliminates the need to spread pipe, reducing undue pipe stress and misalignment while the seat stays in place.
- Cost savings – Saves man-hours, and increases process run time.
- No tools required – No special tools are required to change the spectacle plate position.
- Visible indication of blind position – Constant indication of open/closed position.

AVAILABLE OPTIONS

- Flanged or butt weld connections
- A-105, 304L, 316L, Hastelloy, Titanium
- Variety of seals for specific applications
- 150 lb and 300 lb class standard
- Up to 1500 lb class available

APPLICATIONS

Petrochemical applications:

- Production and Refining
- Pipelines
- Gas gathering (including sour gas service)
- CO₂/Well injection
- Cokers

Slurry applications:

- Cement plants
- Mining

Marine applications:

- Ships, tankers, and barges
- Terminals and storage facilities

Processing applications:

- Chemical
- Food and beverage
- Pulp and paper
- Plastics
- LNG, cryogenic

Engineering Data

Strahman utilizes design software and FEA (Finite Element Analysis) with extensive physical testing to ensure product compliance with all applicable industry standards.

ASTM / ANSI STANDARD

- B16.5 Pipe flanges and flanged fittings
- B16.34 Valves – flanged, threaded and welding end
- B31.1 Power piping

ASME STANDARD

- Section 2 Material
- Section 8 Rules for construction of pressure vessels
- Section 9 Welding and brazing qualifications

API STANDARD

- 897 Valve inspection and testing
- 6FA Fire safety test
- API 598

MSS STANDARD

- SP-25 Marking system for valves, fittings, flanges and unions
- SP-55 Quality standard for steel castings for valves, flanges and fittings, and other piping components (visual method)

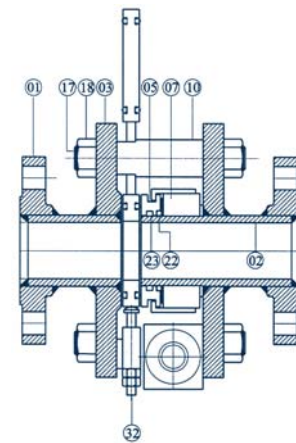
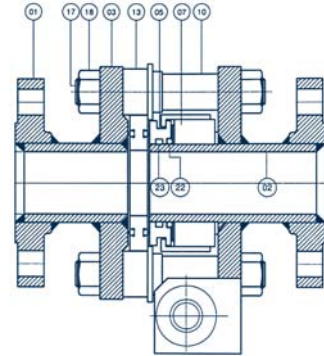

Materials of Construction

Part Number	Part Name	Carbon Steel Blind	304 SST Blind	316 SST Blind
1	Flange	ASTM A105	ASTM A182 F304	ASTM A182 F316L
2	Pipe	ASTM A106	ASTM A312 F304	ASTM A312 F316L
5	Seat	ASTM A240-304	ASTM A240-304	ASTM A240 316L
7	Seat Actuator	ASTM A182-304	ASTM A182-304	ASTM A182-304
17	Screw Shaft	ASTM A479-304	ASTM A479-304	ASTM A479-304
18	Nut	ASTM A194 2H	ASTM A193 B8	ASTM A193 Gr8
22	Sealing Gasket*	Per Application	Per Application	Per Application
23	Wiper Ring*	PTFE/Graphite	PTFE/Graphite	PTFE/Graphite
32	End Plate	304SST	304SST	304SST

Other materials such as Titanium, Stainless Steel, Hastelloy and other special materials are available.

*Viton, Buna-N, TFE, AFLAS, EDPM, Neoprene, EPR, Graphite

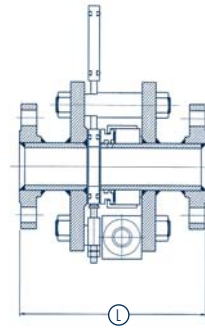
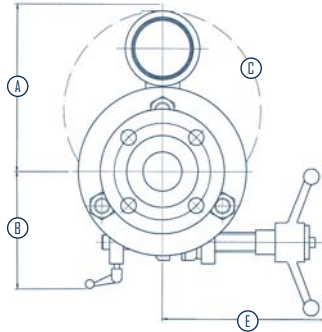

Standard Dimension 740 Series Line Blind

CLASS 150

Size							Weight (Net)	
Inches	DN _(mm)	L	A	B	C	E	lb	
1/2-1	15-25	6.50"-165 _{mm}	5.31"-135 _{mm}	3.15"-80 _{mm}	6.50"-165 _{mm}	5.35"-136 _{mm}	19.84	
1.5	40	7.48"-190 _{mm}	6.81"-173 _{mm}	4.00"-101.5 _{mm}	8.39"-213 _{mm}	6.89"-175 _{mm}	33.07	
2	50	8.50"-216 _{mm}	7.70"-195.7 _{mm}	4.35"-110.5 _{mm}	9.51"-241.5 _{mm}	7.80"-198 _{mm}	55.15	
2.5	65	9.17"-233 _{mm}	8.78"-223 _{mm}	4.80"-122 _{mm}	10.75"-273 _{mm}	8.58"-218 _{mm}	59.53	
3	80	9.17"-233 _{mm}	10.38"-263.7 _{mm}	5.45"-138.5 _{mm}	12.92"-328.2 _{mm}	10.16"-258 _{mm}	74.96	
4	100	9.65"-245 _{mm}	11.75"-298.5 _{mm}	6.18"-157 _{mm}	14.76"-375 _{mm}	11.26"-286 _{mm}	114.64	
6	150	11.26"-286 _{mm}	16.56"-420.5 _{mm}	7.99"-203 _{mm}	20.84"-529.3 _{mm}	12.91"-328 _{mm}	191.81	
8	200	12.28"-312 _{mm}	20.08"-510 _{mm}	9.65"-245 _{mm}	25.39"-645 _{mm}	15.16"-385 _{mm}	279.99	
10	250	12.99"-330 _{mm}	24.59"-624.5 _{mm}	11.10"-282 _{mm}	30.98"-787 _{mm}	16.38"-416 _{mm}	418.89	
12	300	14.80"-376 _{mm}	28.84"-732.5 _{mm}	12.61"-320.4 _{mm}	36.30"-922 _{mm}	18.78"-477 _{mm}	606.28	
14	350	16.57"-421 _{mm}	33.07"-840 _{mm}	13.50"-343 _{mm}	42.72"-1085 _{mm}	20.87"-530 _{mm}	844.39	

CLASS 300

Size							Weight (Net)	
Inches	DN _(mm)	L	A	B	C	E	lb	kg
1/2-1	15-25	7.09"-180 _{mm}	5.31"-135 _{mm}	3.15"-80 _{mm}	6.50"-165 _{mm}	5.35"-136 _{mm}	19.84	9
1.5	40	7.48"-190 _{mm}	6.81"-173 _{mm}	4.00"-101.5 _{mm}	8.39"-213 _{mm}	6.89"-175 _{mm}	39.68	18
2	50	8.50"-216 _{mm}	7.70"-195.7 _{mm}	4.35"-110.5 _{mm}	9.51"-241.5 _{mm}	7.80"-198 _{mm}	57.32	26
2.5	65	9.17"-233 _{mm}	8.78"-223 _{mm}	4.80"-122 _{mm}	10.75"-273 _{mm}	8.58"-218 _{mm}	72.75	33
3	80	11.14"-283 _{mm}	10.38"-263.7 _{mm}	5.45"-138.5 _{mm}	12.92"-328.2 _{mm}	10.16"-258 _{mm}	92.60	42
4	100	12.01"-305 _{mm}	11.75"-298.5 _{mm}	6.18"-157 _{mm}	14.76"-375 _{mm}	11.26"-286 _{mm}	178.58	81
6	150	15.87"-403 _{mm}	16.56"-420.5 _{mm}	7.99"-203 _{mm}	20.84"-529.3 _{mm}	12.91"-328 _{mm}	299.83	136
8	200	16.50"-419 _{mm}	20.08"-510 _{mm}	9.65"-245 _{mm}	25.39"-645 _{mm}	15.16"-385 _{mm}	432.11	196
10	250	17.99"-457 _{mm}	24.59"-624.5 _{mm}	11.10"-282 _{mm}	30.98"-787 _{mm}	16.38"-416 _{mm}	566.60	257
12	300	19.76"-502 _{mm}	28.84"-732.5 _{mm}	12.61"-320.4 _{mm}	36.30"-922 _{mm}	18.78"-477 _{mm}	879.66	399
14	350	30.00"-762 _{mm}	33.07"-840 _{mm}	13.50"-343 _{mm}	42.72"-1085 _{mm}	20.87"-530 _{mm}	1225.79	556

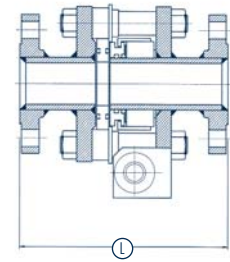
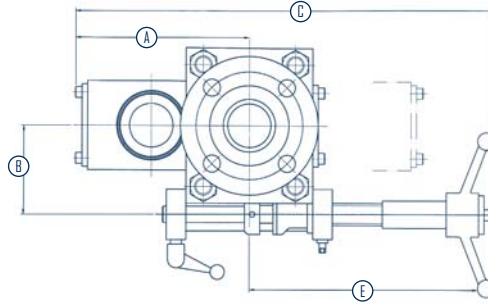

Standard Dimension 760 Series Line Blind

CLASS 150

Size							Weight (Net)	
Inches	DN(mm)	L	A	B	C	E	lb	kg
1/2-1	15-25	6.50"-165mm	5.35"-136mm	3.56"-90.5mm	10.71"-272mm	7.56"-192mm	22.05	10
1.5	40	7.48"-190mm	6.44"-163.6mm	4.33"-110mm	14.65"-372mm	8.90"-226mm	33.07	15
2	50	8.50"-216mm	7.42"-188.5mm	4.57"-116mm	14.84"-377mm	10.55"-268mm	55.12	25
2.5	65	9.17"-233mm	8.94"-227mm	5.31"-135mm	18.23"-463mm	12.64"-321mm	59.53	27
3	80	9.17"-233mm	9.64"-244.8mm	6.12"-155.5mm	20.42"-518.6mm	14.69"-373mm	74.96	34
4	100	9.65"-245mm	10.91"-277mm	6.61"-168mm	22.95"-583mm	15.98"-406mm	108.03	49
6	150	11.26"-286mm	14.37"-365mm	8.37"-212.5mm	30.24"-768mm	20.39"-518mm	180.78	82
8	200	12.28"-312mm	16.98"-431.3mm	9.90"-251.5mm	35.42"-899.6mm	23.46"-596mm	268.97	122
10	250	12.99"-330mm	21.36"-542.5mm	11.44"-290.5mm	43.02"-1092.6mm	28.35"-720mm	399.04	181
12	300	14.80"-376mm	23.58"-599mm	12.78"-324.5mm	48.17"-1223.6mm	29.13"-740mm	648.17	294
14	350	16.57"-421mm	27.17"-690mm	13.78"-350mm	55.71"-1415mm	32.09"-815mm	811.32	368

CLASS 300

Size							Weight (Net)	
Inches	DN(mm)	L	A	B	C	E	lb	kg
1/2-1	15-25	7.09"-180mm	5.35"-136mm	3.56"-90.5mm	10.71"-272mm	7.56"-192mm	22.05	10
1.5	40	7.48"-190mm	6.44"-163.6mm	4.33"-110mm	14.65"-372mm	8.90"-226mm	39.68	18
2	50	8.50"-216mm	7.42"-188.5mm	4.57"-116mm	14.84"-377mm	10.55"-268mm	57.32	26
2.5	65	9.17"-233mm	8.94"-227mm	5.31"-135mm	18.23"-463mm	12.64"-321mm	72.75	33
3	80	11.14"-283mm	9.64"-244.8mm	6.12"-155.5mm	20.42"-518.6mm	14.69"-373mm	92.60	42
4	100	12.01"-305mm	10.91"-277mm	6.61"-168mm	22.95"-583mm	15.98"-406mm	171.96	78
6	150	15.87"-403mm	14.37"-365mm	8.37"-212.5mm	30.24"-768mm	20.39"-518mm	288.81	131
8	200	16.50"-419mm	16.98"-431.3mm	9.90"-251.5mm	35.42"-899.6mm	23.46"-596mm	418.89	190
10	250	17.99"-457mm	21.36"-542.5mm	11.44"-290.5mm	43.02"-1092.6mm	28.35"-720mm	546.76	248
12	300	19.76"-502mm	23.58"-599mm	12.78"-324.5mm	48.17"-1223.6mm	29.13"-740mm	842.18	382
14	350	30.00"-762mm	27.17"-690mm	13.78"-350mm	55.71"-1415mm	32.09"-815mm	1190.52	540

The Strahman family of products also includes:

S A M P L I N G V A L V E S

Strahman has a full line of sampling valves that produce live samples without exception. Our sampling valves are designed to prevent failure caused by sediment or clogging.

D R A I N V A L V E S

Strahman Drain Valves are designed so that they cannot clog. They are ideal for use in liquid and gas service or with slurries, polymers, and high viscosity fluids which may solidify at room temperature.

W A S H D O W N E Q U I P M E N T

Strahman has a full line of mixing unit-hose stations, hoses, nozzles and accessories. Request our wash down equipment catalog.

L I N E B L I N D V A L V E S

Strahman Line Blind Valves provide zero leakage and total isolation on process pipelines, vessels, and maritime applications. No pipeline movement is required when blind position is changed.



Corporate Headquarters:

Strahman Valves, Inc., 2801 Baglyos Circle, Bethlehem, PA 18020
Tel: 484.893.5080 • Fax: 484.893.5099

France:

Savoie Hexapole, F-73420 Mery, France
Tel: 33 4 79 35 78 00 • Fax: 33 4 79 35 78 20

Germany:

Eisenbahnstrasse 104a
D-77833 Ottersweier, Germany
Tel: 49 7223 22057 • Fax: 49 7223 20165